

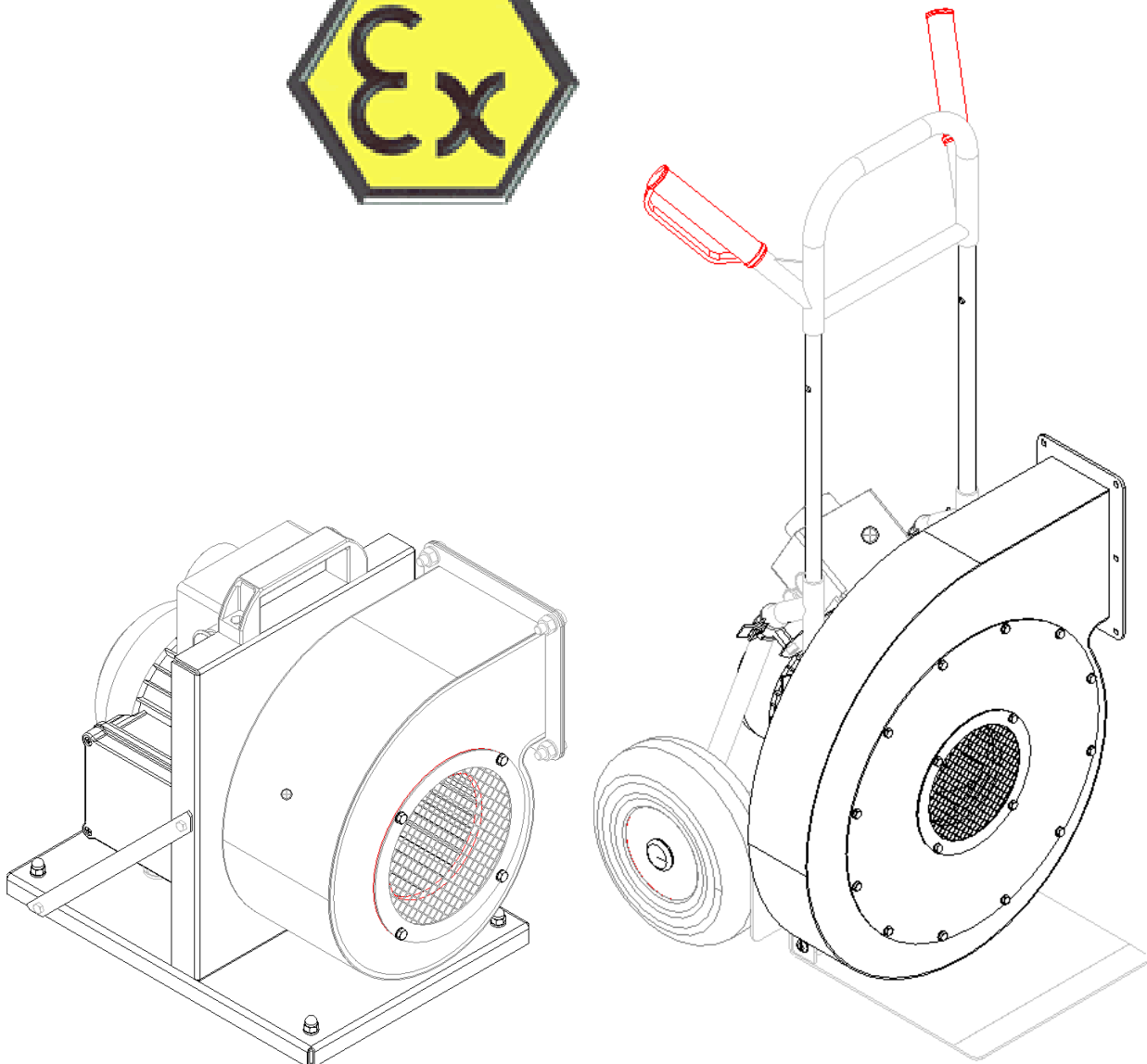

User manual

**for mobile radial fans designated for use
with potentially explosive atmospheres
according to zones 1, 2 and 22**



Printed in Germany

We reserve the right to make changes via technical development compared with the details and illustrations in these operating instructions. Reproduction, translation and copying in any form – even in part – subject to written approval from the manufacturer.

These operating instructions will not be subject to any change service.
Please contact the manufacturer for the current status.

KARL KLEIN Ventilatorenbau GmbH
Waldstrasse 24
73773 Aichwald
Phone.: 07 11 - 36 90 6-0
Fax.: 07 11 - 36 90 6-950
Internet: www.karl-klein.de
e-mail: info@karl-klein.de

Status: 07/2019

Contents

1	Preliminary notes.....	3
1.1	Notes from the manufacturer to the operator	3
1.2	The tasks of fan operators in potentially explosive atmospheres	5
1.3	Warranty	6
1.4	Symbols used	7
1.5	Name and instruction plates	8
2	Proper use	9
2.1	Limits of use and features of proper use	9
2.2	Improper use.....	10
3	Safety	11
3.1	Basic safety information.....	11
3.2	Emissions	13
3.2.1	Dust, gases and vapours	13
3.2.2	Noise.....	13
3.2.3	Vibrations	13
3.3	Overheating/ambient conditions	13
3.4	Transport and storage	14
4	General function description.....	15
5	Setting up/connection/commissioning/operation	16
5.1	General safety instructions	16
5.2	Setting up, connecting and installing	17
5.3	Assembly and installation instructions for potentially explosive atmospheres	17
5.4	Fan connection	18
6	Information on maintenance, care and repair	19
6.1	Maintenance and care	19
6.2	Check bearings.....	19
6.3	Maintain the supporting frames and chassis in working order	19
6.4	Repair notes and procedures	20
6.5	Contamination in case of repair returns.....	20
7	Disposal.....	20
8	EC-Declaration of Conformity	21

1 Preliminary notes

1.1 Notes from the manufacturer to the operator



Please follow the safety instructions.

Please read carefully all safety instructions in these operating instructions.

Familiarize yourself with the handling of the fan before starting work.

It will be too late to do so once you are working.

Do not allow anyone without the specialist knowledge to turn on and use this fan.

Validity

These operating instructions apply to all mobile ATEX fans with the following descriptions:



MRV-... II(2 oder 3)G Ex h II(B oder C) (T3 oder T4) G(b oder c)

and



MRV-... II(2 oder 3)D Ex h IIIC T125°C D(b oder c)

Purpose of these operating instructions

These operating instructions will be provided with the scope of delivery. They also serve as assembly instructions.

The manufacturer drew up these operating instructions based on its knowledge and experience in construction, manufacturing and operation.

They can be complemented by special instructions by the operator (e.g., for supervision and obligatory registration, in-house maintenance and servicing schedules).

Symbolic illustration in these operating instructions

The graphic illustrations and drawings represent the main view of a fan. They are not to scale neither do they show the proportions of each fan from the delivery range.

The illustrations are only intended as a guide.

The detailed dimensions and views are listed in the catalogue and available from the manufacturer.

Copyright

The copyright to these instructions remain with KARL KLEIN Ventilatorenbau GmbH.

The operating instructions may not be reproduced or made available to unauthorized third parties or persons in part or in whole without prior approval from KARL KLEIN Ventilatorenbau GmbH.

You as the operator will be responsible for

- the fan only being used by trained specialist personnel,
- adherence to the safety regulations and safety instructions and the health and safety at work precautions,
- the technical training of the operating personnel and their familiarization with the operating instructions.

1.2 The tasks of fan operators in potentially explosive atmospheres

What are essential here are the national prescriptions equal to the German Industrial Safety Ordinance (BetrSichV), the Equipment and Product Safety Act (GPSG) and the 11th Ordinance on the Equipment and Product Safety Act (11th GPSGV - Explosion Prevention Ordinance). They impose certain measures on equipment operators for their use in potentially explosive atmospheres.

According to European directive 2006/42/EC and to article 3 of the German Industrial Safety Ordinance or equal national prescriptions of other members of the EU, the operator must carry out a hazard assessment in the area where the equipment is to be used. This should recognize and take account of the hazards that may occur when using the equipment in connection with the materials and the working environment.

According to European directive 2006/42/EC and to article 4 of the German Industrial Safety Ordinance or equal national prescriptions of other members of the EU, the operator must take the necessary measures and select the equipment most suitable to the conditions at the workplace and has to ensure health and safety at work when used properly.

For carrying out the hazard assessment and selecting suitable equipment, the operator must apply European Parliament and Council Directive 2006/42/EC on Industrial Safety and Directive 99/92/EC (the ATEX Directive for operators) and the respective harmonized norms (EN), e.g., EN 60079, Electrical apparatus for potentially explosive gas atmospheres or EN 1127-1, Explosive atmospheres.

The operator will be solely responsible for selecting the suitable equipment (fan) for the envisaged area and the envisaged application.

1.3 Warranty

KARL KLEIN Ventilatorenbau GmbH undertakes to provide a warranty within the framework of its general conditions of sale and delivery.

Claims under the warranty will expire if the assembly instructions and procedures and in particular, the proper use as described in these operating instructions are not adhered to.

No unauthorized conversions or changes may be made to the fan.
Only use original parts and accessories approved by KARL KLEIN Ventilatorenbau GmbH.
Using other parts may affect operation.
The operator will be liable for any damage arising.

KARL KLEIN Ventilatorenbau GmbH will not be liable nor will it provide any warranty with respect to repairs carried out by yourself or for defective assembly of the fan.

1.4 Symbols used

The following symbols will be used in these operating instructions. They support the instructions on safety and damage prevention.



Attention: power surge!

This describes possibly hazardous situations. Failure to observe such warnings can lead to death, serious injury or material damage.



Attention!

This describes possibly hazardous situations. Failure to observe this can lead to injury or damage.



Note:

Instructions how to use the delivered equipment for optimal operation and other useful information.



Note!

Read safety instructions in user manual carefully before operating the fan.



Attention!

Caution on hot surface.



Instruction: Wear hearing protection!

Hearing protection must be worn during working on / behind the machine

Name and instruction plates



Note:

Type plates can be found on the air conveying part of the fan, on the on-off switch and on the drive motor.

The data on the type plates are important for the proper use of the appliance. All plates must be legible at all times. Illegible and lost type plates and warning plates must be replaced immediately.

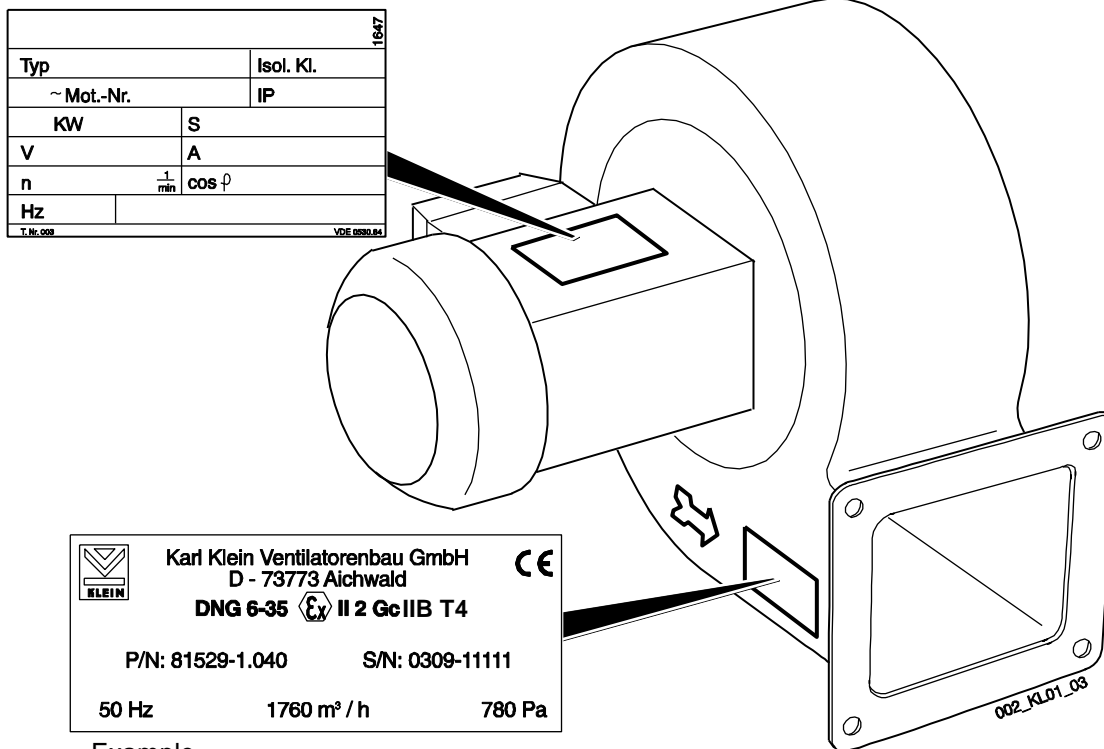

Example

The details on the name plates identify the respective fan type, the performance and describe the nature of the explosion protection.

The details on the name plate correspond to the performance requirements ordered. These can change.



Note:

The values stated on the name plate are decisive.

Please see the order confirmation for further approved values.

2 Proper use



Note:

The fan is labelled II(2 or 3)G Ex h II(B or C) (T3 or T4) G(b or c) or II 3Dc IIIC T125° C Dc

Appliance group II; Category 2 or 3; G = Gas; D = Dust; Ex h = Constructive safety

T3 = to 200° C surface temperature

T4 = to 135° C surface temperature

IIB or IIC= explosion subgroup

IIIC = conductive dust

T125° C = plain text details for dust explosion protection to 125° C surface temperature

Gb, Gc and Dc = Equipment Protection Level.



This KLEIN fan was designed and built for transporting non-aggressive and non-abrasive media. The fan can be used for extraction from potentially explosive atmospheres in zones 1, 2 and 22 (in accordance with directive 94/9/EC until April 19th 2016 and in accordance with directive 2014/34/EC from April 20th 2016 on).

For *Zone 1*, this means that the fan is intended for use in such areas in which it is to be expected that an explosive atmosphere as a mixture of flammable substances in the form of gas, vapour or mist will occasionally occur with air during normal operation.

For *Zone 2*, this means that the fan is intended for use in such areas in which it is to be expected that an explosive atmosphere as a mixture of flammable substances in the form of gas, vapour or mist will not occur with air during normal operation. If this does however occur, this will only last for a short period.

For *Zone 22*, this means that the fan is intended for use in such areas in which it is to be expected that an explosive atmosphere as a mixture of flammable substances in the form of dust will not occur with air during normal operation. If this does however occur, this will only last for a short period.

Proper use also includes the observance of and adherence to the directions and information in these operating instructions.

2.1 Limits of use and features of proper use

Proper use includes the following:

- The conveying medium may not contain any solid or liquid contamination. Place a filter by the fan intake if necessary (see KLEIN accessories list). Protective grids are also required on the inlet and outlet side.
- Ventilated air flow at fan inlet with higher or lower values than the specified limits of 0.8 to 1.1 bar for absolute pressure and –20°C to +60°C for temperature are not permitted, max. allowed oxygen content is 21 volume percent.
- Ambient atmospheres with higher or lower values than the specified limits of 0.8 to 1.1 bar for absolute pressure and –20°C to +40°C for temperature are not permitted, max. allowed oxygen content is 21 volume percent.
- Only use the fan with the inlet and outlet protective grids in place.
- No shocks, vibrations or oscillations may be transferred to the appliance from outside as these may impair the impeller balance leading to dangerous vibrations.

2.2 Improper use

Improper and hazardous use include in particular

- conveying explosive or flammable media in zones 0 or in the zones 20 or 21 for dust
- operation of the fan in a zone 0, 20 or 21 -ambient
- conveying ionized gases or hot ignitable mixtures exceeding temperatures of +60° C at the fan inlet
- conveying gas mixtures that contain other chemical reaction partners;
- conveying abrasive media;
- conveying without suitable inlet and outlet protective grids;
- operation without motor overload switch;
- transporting/carrying persons on the fans/frames;
- transporting/placing additional/foreign loads on the fans/frames;
- continued operation after toppling over or after the appliance has been exposed to strong vibrations/shocks;
- operation without continuous earthing/potential equalization;
- operation outdoors, exposed to the elements, solar radiation, lightening, without weather proofing or different from the established IP protection class;
- any other use deviating from proper use thus leading to danger.
- Travelling on uneven ground connected with shocks or vibrations, driving up or down over stairs or landings or the corresponding displacing of the appliance as well as spark creating transport / sliding should be generally avoided. An appliance may not be operated further once it has toppled over. This kind of use can for example, impair the balance of the impeller in such a way as to lead to adverse conditions such as impeller breaks, ignition risks, damage to objects and personal injury. The appliance should be returned to the manufacturer for repair if it topples over or sustains shocks or hazardous vibrations.

3 Safety

3.1 Basic safety information

KLEIN fans are designed and built according to recognized rules of technology, health and safety regulations and the requirements of Directive 94/9/EC (until April 19th 2016) resp. Directive 2014/34/EC (from April 20th 2016 on) for appliances and protective systems for proper use in potentially explosive atmospheres and according to the requirements of the Equipment and Product Safety Act (GPSG). They correspond to the latest technology.

The use of fans can however lead to hazards, in particular,

- improper use or
- inappropriate use

can lead to hazardous situations

All instructions on the use of the fan must therefore be adhered to.



Note:

- The fan may only be used in a technically perfect condition and with undamaged electrics. Use of a defective appliance or an unbalanced impeller can be fatal.
- No materials that may be easily drawn in, e.g., polystyrene or cloths may be around the inlet area. Ensure sufficient distance to the suction inlet. The suction inlet may not be covered by items sucked in. The fan may only be used with a protective grid fitted on the suction side.
- Pay attention to the direction and area of air outlet. Any breaks to the paddle wheel may not lead to subsequent personal or material damage. The fan may only be used with a protective grid fitted on the outlet side.
- This fan may never be operated without the protection grids installed both on the suction and on the outlet side.
- This fan may not be operated under zone 0 conditions! Neither conveying medium into a zone 0 area nor conveying out of an zone 0 area are allowed!
- Depending on the size of the fan and how it is installed, there may be a considerable suction effect near the inlet area and a considerable blowing effect near the outlet area. The operators must take all measures to exclude any hazards due to this conduct by the fan.
- Electrical protective devices must correspond to the requirements of the machine in combination with which the fans are palled to be operated (e.g., motor overload switch, etc.).
- The personnel must be familiar with all measures describing the proper handling and specialist appropriate use of this appliance in these operating instructions.
- The operator should stipulate to its employees the nature and the wearing of personal protective equipment in a suitable manner and to an appropriate extent and ensure that this is adhered to. Especially, clothing and personal protective equipment have to correspond to the demands of explosion protection.
- You may not repair explosion protected fans yourself. Fans may only be repaired or preventively maintained by the manufacturer in order to maintain their explosion protection.
- The customer/operator is responsible for training and instructing the workers/employees.

3.2 Emissions

3.2.1 Dust, gases and vapours

The occurrence of hazardous emissions depends on the respective medium to be conveyed. Measures for safety and health protection have to be carried out by the operating company.

3.2.2 Noise



The level of noise depends on the type of installation, the kind of mounting, environmental conditions and the respective operating point of the fan.

Certain kinds of use can cause the fan to develop running noises that can reach a high level. Noise levels can be between 60 and 110 dB (A). Please see the KLEIN catalogue for details on noise levels.

If unavoidable work is to be carried out nearby, the operator should take appropriate noise protection measures in the context of his responsibility under the Industrial Safety Ordinance (BetrSichV) (e.g., hearing protection).

3.2.3 Vibrations

The balancing quality of KLEIN fans is such high quality that no dangerous vibrations occur ex-factory.

No shocks, vibrations or oscillations may however be transferred to the appliance from outside as these may impair the balance leading to dangerous operating conditions.

3.3 Overheating/ambient conditions

During every phasis of operation the machine has to be operated under sufficient cooling. E.g. the machine is not allowed to be covered, The max. allowed ambient and medium temperature may not be exceeded. No operation under direct solar radiation or nearby heat sources allowed.

This device may not be operated under ambient conditions or under weather influence.

3.4 Transport and storage



Note:

For transport to the operation site, use a lifting strap and secure the fan in such a way that it remains balanced.
Only transport with suitable slinging and lifting gear for transporting. Avoid the appliance tipping over.



Attention!

Transporting can pose a danger of bruising and crushing between the fan, the frame and the surroundings.

Unsuitable slinging and lifting gear can lead to the appliance falling down onto items or persons.

Moving or transporting the fan over stairs or staircases may dangerously impair the balance of the impeller and is therefore not permitted. Landings must be crossed free of vibration, slowly and with care. ^

Please ensure that the earthing strap is in proper function meanwhile transport.



Note:

Dispose of packaging properly. Do not burn.



Notes on storage

Only store the fan in closed dry spaces wherever possible prior to transport to the installation location.

Storage in open covered areas is only permissible for short periods.

Protect the fan from all damaging environmental influences and mechanical damage.

In the event of storage while out of operation, ball bearings (in the motor) may no longer be used and should be replaced no later than after two years or even earlier depending on the condition of the bearings. Please also study the documentation supplied for the motor.

4 General function description

KLEIN fans are radial fans with ball-bearing mounted electric drive.

The respective medium will be drawn in axially and discharged radially in the desired direction (see fig.).

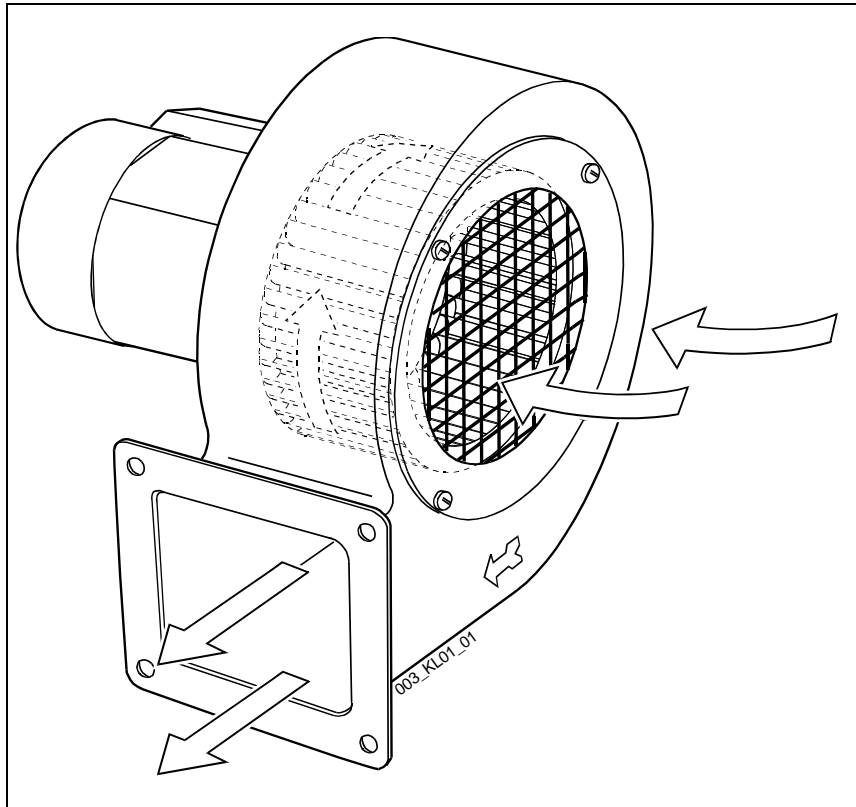

Flow direction of the medium

5 Setting up/connection/commissioning/operation

5.1 General safety instructions



Attention! Danger to life due to power surge

There is a danger of power surge when connecting to the mains if not switched off previously. Carry out any connection, installation and any kind of repair work in absence of explosion endangerment !

Always switch off the power before working on current carrying parts.

- The electrical connection may only be carried out by properly qualified and specialist trained electricians who can provide evidence of knowledge regarding setting up, connecting, commissioning and operation in potentially explosive atmospheres.
- Setting up and operation may only take place on horizontal level surfaces. Components fitted on the operator side may not affect the stability of the delivery of the fan and the frame. The operator will have to carry out additional safety/securing measures if necessary.
- Both the carrying of models with supporting frames and the tilting over and rolling models with mobile frames require minimum physical conditions and the wearing of suitable personal protective equipment such as sturdy safety shoes. The ergonomic principles for raising and lowering loads must be adhered to.
- Only use spark-inhibiting tools when setting up and installing in potentially explosive atmospheres.
- Electrical leads, command lines, etc. as well as hose lines and ventilation connections should be laid in such a way that either they cannot be driven over or so that they are reliably protected from being deformed or damaged when driven over. No loads may be placed on any electrical leads, command lines, etc. or on any hose lines or other ventilation connections. Cables must be wound up and stored in such a way that no bends, kinks or knots occur. Air leads may not be operated if they are bent or blocked.
- The operator must point out the hazards of stumbling due to connected hose lines, cables, etc. Cable, hose and pipe channels must be labelled and secured.
- The customer/operator may not carry out any changes to the electrical equipment supplied. The cable length and plugs supplied may not be removed, replaced or changed. Unless this has not been ordered, the operator must use the approved suitable mating plug with the plug that has been supplied.
- Specialist electricians are persons who are familiar with setting up, assembly, commissioning and operating the appliance/machine and who possess qualifications relating to their activities or who have undergone training or instruction according to the standards of safety technology in maintaining and using appropriate safety equipment as well as accident prevention.
- Setting up, connecting, commissioning and operation are, on the part of the operator/customer, dependent on the on site requirements of the fan and the function-specific conditions relating to the set-up and operation site (with respect to the machine or the appliance). The customer/operator will bear the responsibility for the proper use and maintenance of safety and health protection during all life phases from the point of taking over the product.

5.2 Setting up, connecting and installing



Note:

The connection lead with the plug has been pre-manufactured and may not be changed. If this is not included in the delivery by the manufacturer, the customer/operator should provide and connect a suitable, approved mating plug. There may be no departure from the instructions regarding the electrical connection. Only an appliance that corresponds to the requirements for use and the respective local conditions may be installed and used.

- Mobile models on wheels: For space-saving the handle bar can be slipped in and latched. Meanwhile moving the mobile ATEX fan the handle has to be pulled-out and latched.
- Mobile models on wheels: For operation of the mobile ATEX fans the additional brackets have to be swung out and latched against toppling over. The earthing strap has to be connected professionally.

5.3 Assembly and installation instructions for potentially explosive atmospheres

Further instructions that must be adhered to:



Note:

The method of fastening the fan to the chassis may not be changed. A connection for air conveyance is possible on the outlet flange or the inlet by using connections or intermediate flanges.



Attention!

Connection can pose a danger of the bruising of body parts between the fan, the frame and the surroundings.

On site components such as hose lines, pipes, etc. that have to be connected must have a complete potential equalization to the fan and the chassis.

On site components such as e.g. STORZ- couplings are not allowed to consist out of aluminium because of the danger of thermit reaction in contact with iron oxide particles. These components must consist out of brass or stainless steel.

- The environment should be free of items that may be drawn in if the fan is used in free in-take mode.
- The minimum distance from a wall to the cooling fan cover is: 30 mm.
- The flow velocity in connected ventilation components may not exceed 20 m/s or 10 m/s in filters/silencers.
- Motor protection is included in the on/off switch. It is dimensioned for the motor supplied.

- An on-site motor protection by way of fuses or motor protection switches should correspond to the motor's rated current according to the motor's specifications. The minimum specification for this (nominal current and t_e time) is stated on the motor's type plate.
- The ATEX male connector is mechanically secured and cannot be switched on without mating female plug, refer operating instruction for explosion protected plug and socket system.
- Hose lines must be made in such a way that they cannot build up any electrostatic changes on the inside or outside surfaces. Metallic spirals should be incorporated into them in order to achieve sufficient mechanical stability. These should not collapse, constrict or inflate due to under or over pressure or following laying.
- The metallic spiral is to be laid bare on both ends of a hose line. The bare ends must be linked to the connecting components in an electrically conductive manner so that over the overall assembly or similar measures, there is a complete, constant electrical potential equalization of the overall system.
- The frame is mobile in the case of certain designs. It has additional folding supports that should be used to provide additional support against tipping over. Earthing strap has to be connected.

5.4 Fan connection



Note:

A rigid double connection both on the inlet and outlet side can lead to fan parts being damaged or broken.

Structure-borne noise by electrical conductible disconnecting tarpaulin assembly

Fan connection is possible either on the outlet flange or on the inlet intermediate flange.

Connection examples:

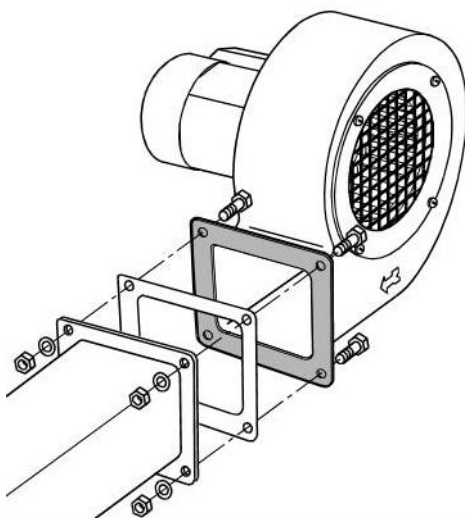

on the outlet flange

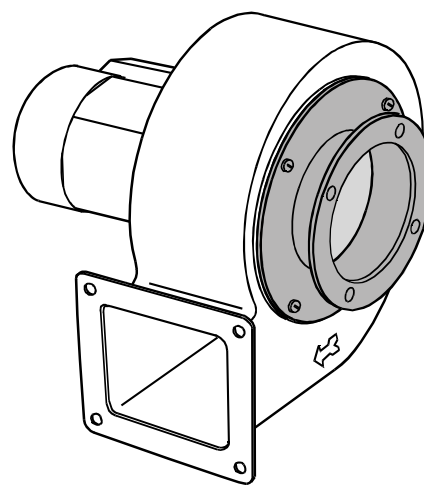

on the inlet intermediate flange

6 Information on maintenance, care and repair



Note:

The operator can also incorporate additional cleaning or maintenance intervals depending on how the fan is to be used and the respective design concept.

Repairing damage or exchanging parts yourself is hazardous. This will render the explosion cover invalid.



Attention! Possibility of material damage

Unbalance will occur if balancing brackets **(1)** are displaced on or removed from the fan blades.

Under no circumstances should you repair the fan yourself. There is a danger of explosion if the appliance is assembled incorrectly and then used.

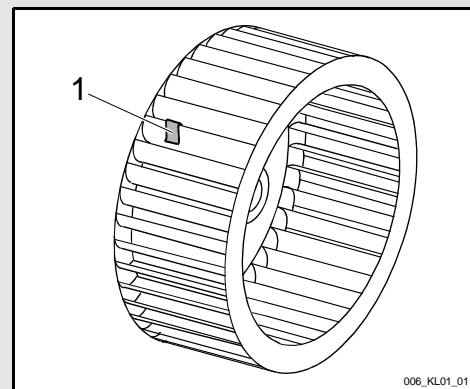

6.1 Maintenance and care

- Check for contamination on the impeller in order to spot and prevent unbalance in time.
- Dust deposits should be regularly removed from parts of the appliance. The maximum permissible thickness of the dust deposits is 3 mm. Use in connection with combustible dust is only permissible in the case of suitability for the respective zone.

6.2 Check bearings

- Ball or roller bearings are part of the explosion-protected motors in the scope of delivery and in the case of the respective type, in the wheels on the chassis. Check at regular intervals the problem-free functioning of the ball or roller bearings by checking for running noise and have these replaced if necessary.
- The motor ball bearings must be replaced by the manufacturer or an authorized workshop at the latest after 20,000 operating hours or at the latest after 3 years, depending on what occurs earlier.

6.3 Maintain the supporting frames and chassis in working order

- Hand-held models: Regularly check the screw connections on the models with supporting frames and tighten these if necessary. There is for example a danger of injury when removing the carrying handle.

- Mobile models on wheels: Regularly check the wheels of the frames and renew these if necessary. The wheels should be exchanged if the tread is worn or the casing is broken. Roller bearings in the rollers: See section 6.2.

6.4 Repair notes and procedures

- Fans that are defective, have fallen over, fail to run in a circular manner or are damaged may no longer be operated. Damaged frames, electrical components, housings or driving rollers or unbalanced or adjusted minimum gap distances increase the risk of explosion. Do not repair appliances yourself, take them to the manufacturer for repair. This is the only place where proper specialist repairs and tested balancing are guaranteed.
- Only qualified personnel may remove the fan from use. The delivery of the fan and frame may also not be separated when being returned for repair.

6.5 Contamination in case of repair returns

- When returning a fan that is dirty or contaminated with hazardous substances, the manufacturer must also be provided with a complete list of the substances contained and potential for danger.
- If this list is missing, the manufacturer may reserve the right to delay the repair until the list has been submitted. In certain cases, the manufacturer may refuse to accept contaminated goods for repair or to return goods delivered, unprocessed and with costs.

7 Disposal

The continued use of defective fans and/or their components such as impellers, rolling bearings, etc., as well as the frame can lead to material damage and personal injury and damage to the environment.

The operator must dispose of all fan components properly in accordance with national and international laws and regulations.

8 EC-Declaration of Conformity



Karl Klein Ventilatorenbau GmbH
Waldstrasse 24
73773 Aichwald - Germany

EC-Declaration of Conformity

We hereby declare that the products:

Mobile Radial Fans:

MRV-...



all types of equipment group II, equipment category 2G, 3G, 2D and 3D type of ignition protection „c” (labeling „Ex h”)

are developed, engineered and manufactured according following Directives:

Machinery Directive 2006/42/EC

ATEX-Directive 2014/34/EC

The labeling of the fans must include following details:

		II (2 or 3)D Ex h IIIC T 125°C D(b or c)
or		II (2 or 3)G Ex h II(B or C) T3 or T4 G(b or c)

Following harmonized standards were applied:

EN ISO 12100:2010

EN 1127-1:2011

EN 80079-36:2017

EN 80079-37:2016

EN 14986:2017

Information: There are separate declarations of conformity of the manufacturers for the electrical components.

The technical documentation for fans of category 2G and 2D are deposited at following notified body:
IBExU Institut fuer Sicherheitstechnik GmbH, Fuchsmuehlenweg 7, D-09599 Freiberg

The authorized person for the summary of the technical documents is the subscriber.

City, date

Aichwald, July 8th 2019

signature and functioning of subscriber

Siegfried Seidler, Head of Engineering

